

The Creative Egg

o

Exposé

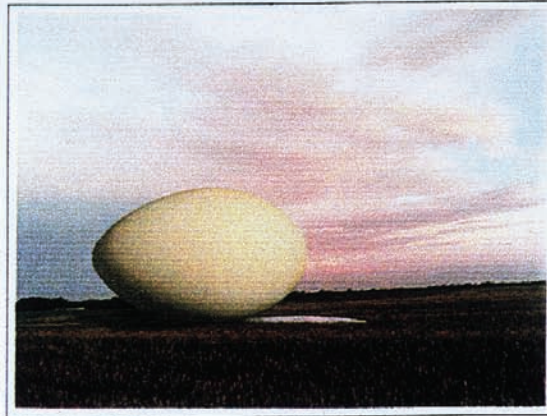

The Creative Egg

An Egg is a symbol for all things new. It holds the promise of new life, energy and optimism.

This project is born out of the conviction that contemporary education simply does not develop the qualities in our children that they need in order to be able to cope with the problems of the future.

The increasing trend towards specialization and competition numbs creativity and the interdisciplinary approach. We lose the quality of insight, care and inspiration.

We feel that it is essential to create a very special space, where the role of mankind and mankind's relationship to the environment can be fundamentally questioned. Also the areas of inner learning which have generally remained unexplored, form an integral part of all the learning in the Egg.

lights on

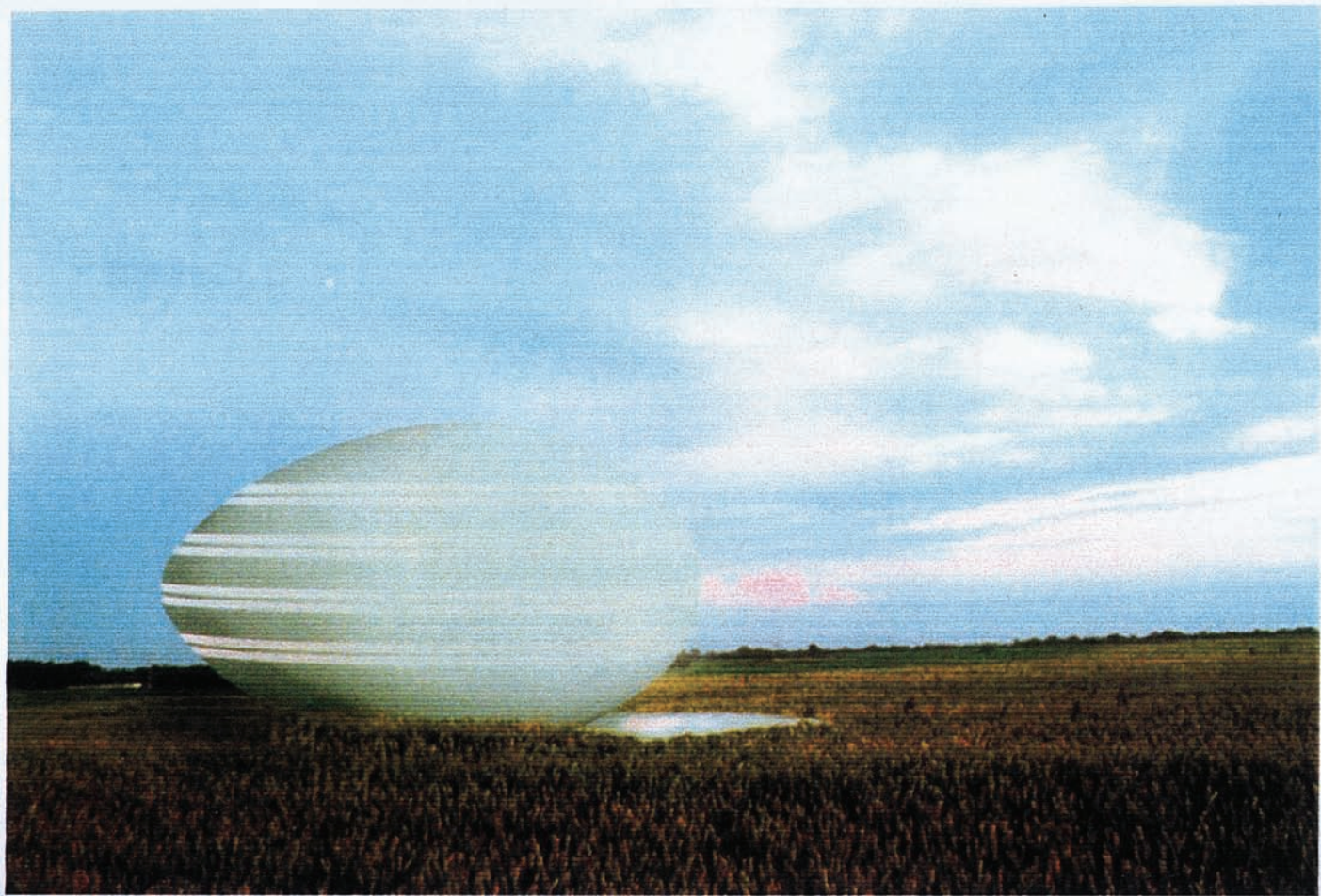

What is this Creative Egg ?

Primarily it is a creativity sanctuary for the young of all ages. It is a place where one goes to discover, experiment, build and create something new.

At a time when families and society are no longer a reliable source of moral, ethical and social guidance, we hope that these fundamental teachings will be integrated in the total experience in the Egg.

We aim to create an atmosphere of quiet harmony and cooperation in which the nature of relationships and responsibilities to each other can be examined in the broadest of contexts.

lights off

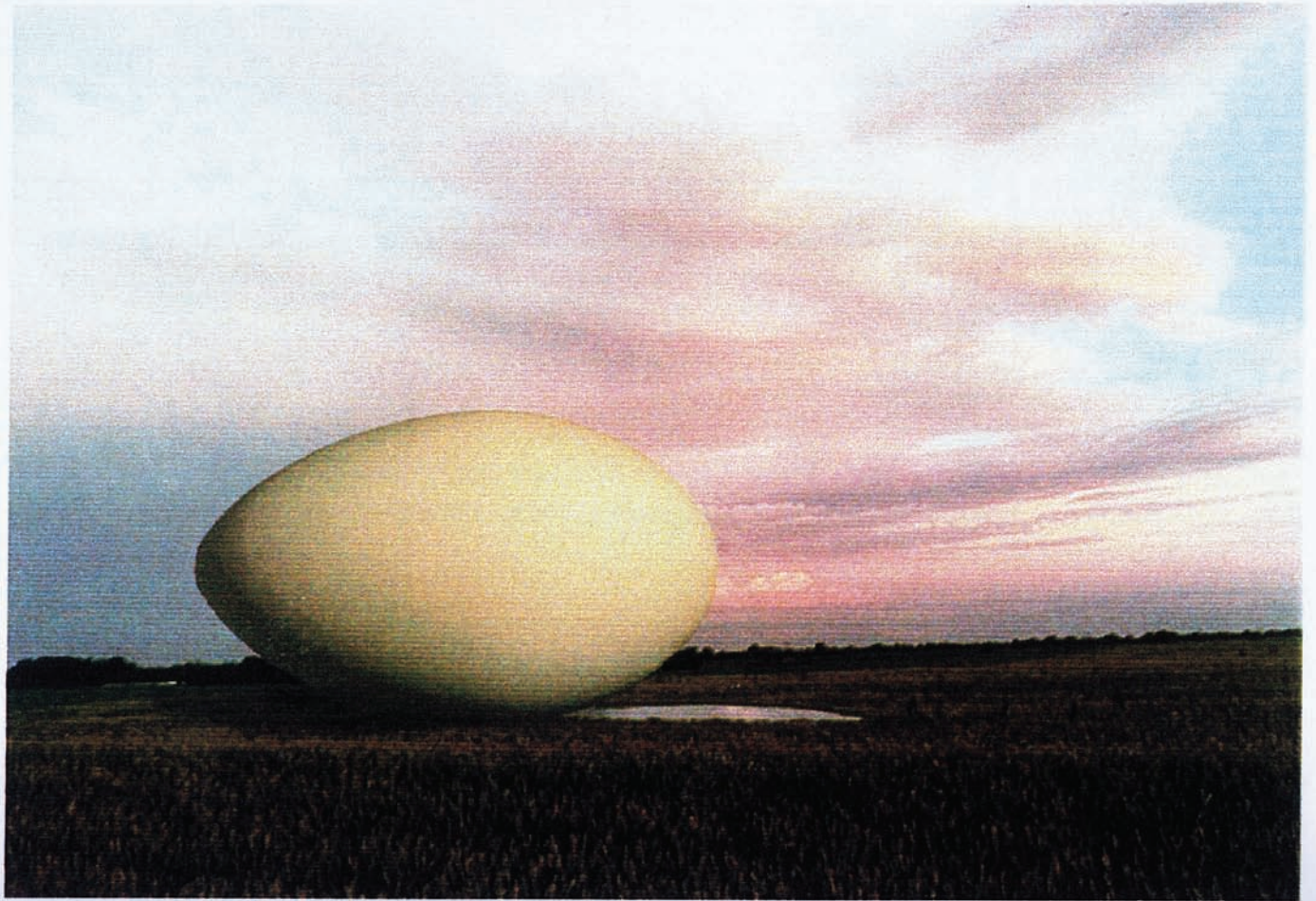

How does the Creative Egg look and why this shape ?

We are determined to create a space which evokes a special atmosphere free from the limitations of conventional thinking. An Egg is the ideal shape for this project. Here all activities are new and inspired as the form suggests.

The visitor is drawn into an atmosphere of peace and quietness. The light is magical, the space is free of tension, yet stimulating. Other elements are at work here. There is no competition, no pressure to win.

Even from a distance, at a glance, one is aware of the presence of something new.

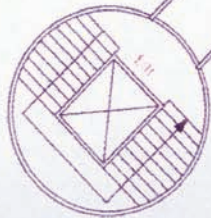
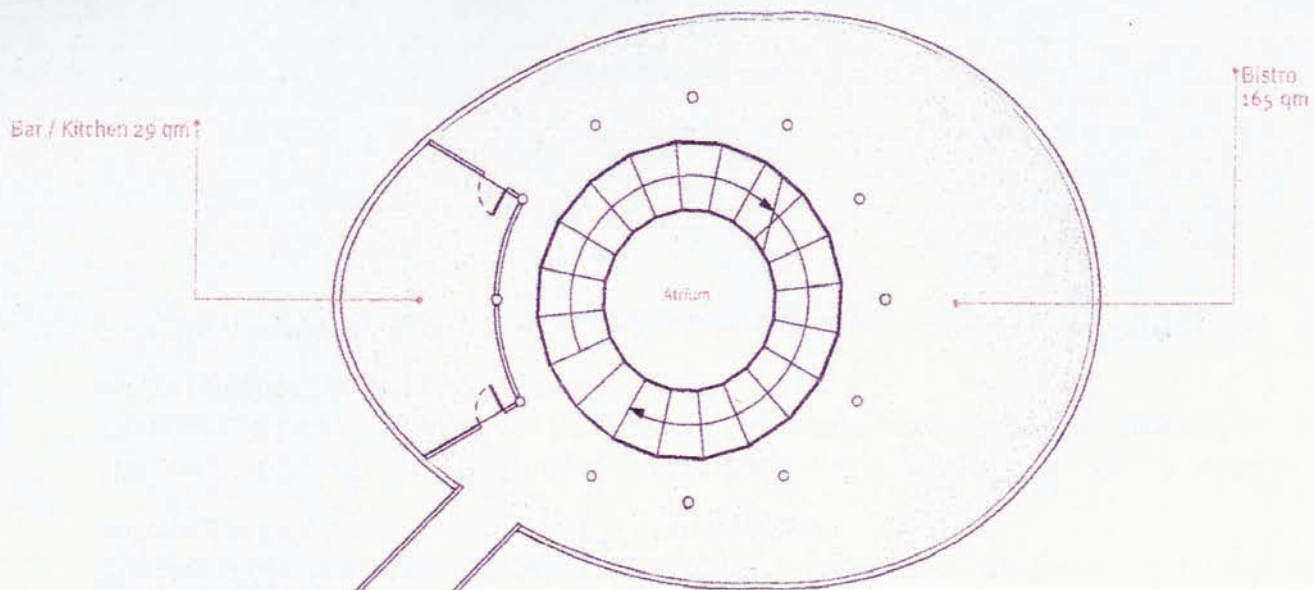

Groundfloor

Bistro 165 qm
Kitchen / Bar 29 qm

Total 194 qm

10.06.96

All rights reserved.

How does the Creative Egg work ?

Divisions of space:

Ground floor:

Bistro / kitchen: preparation of international foods - simple, healthy, palatable to the young. This area will be equipped with beautiful wooden tables and seats in the form of eggs & egg slices. The area shimmers in cream / peach colour.

Picnic area:

For day visitors who wish to consume their own picnic. Here, low wooden tables in the shape of fruit and seats in leaf shape shine in the bright natural colours of fruit and greenery.

Ethnic area:

Provides for all the senses through the authentic experience of harvesting, preparation, storage and consumption of the relevant foods. This we would impliment with subtle, yet effective means of modern exhibition and reconstruction methods.

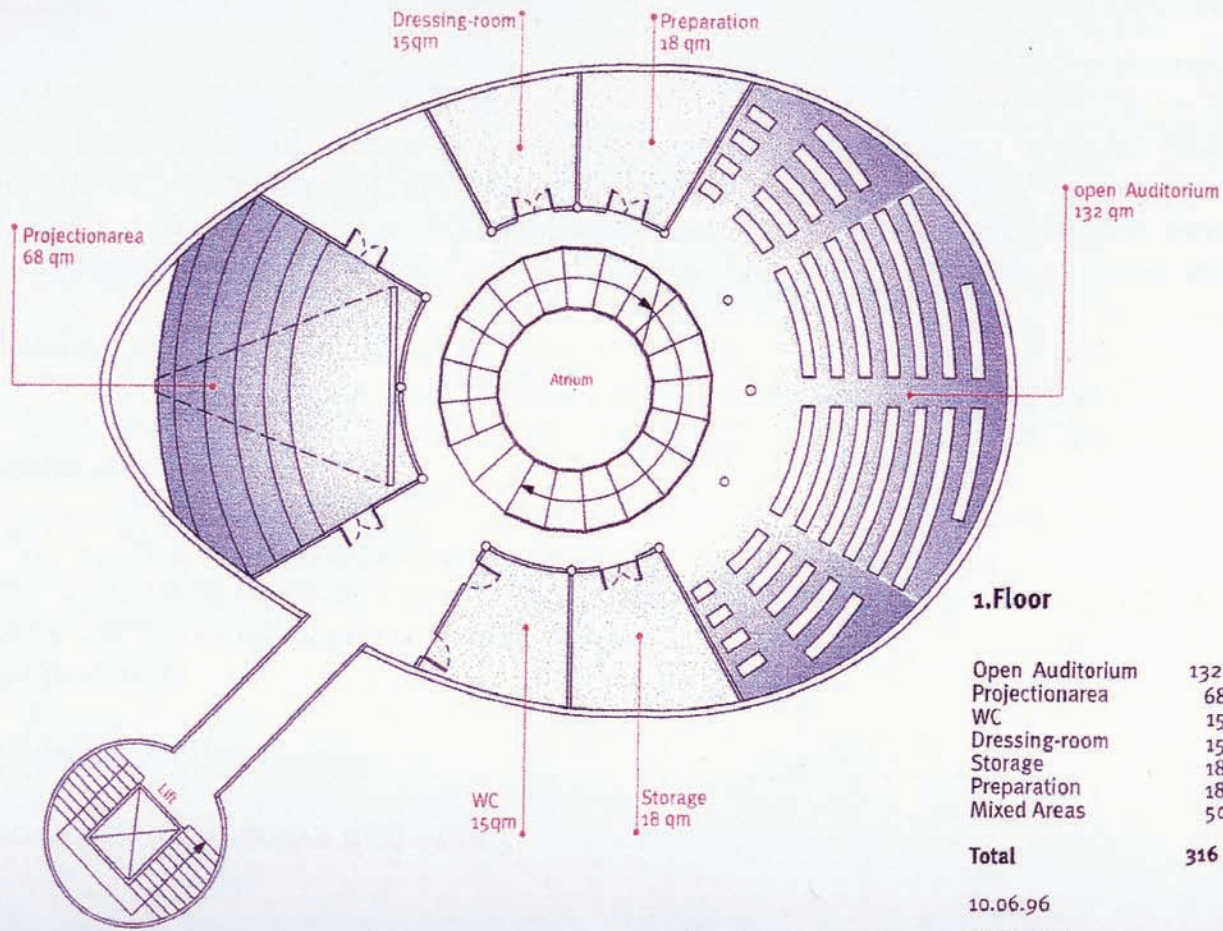

1.Floor

Open Auditorium	132 qm
Projectionarea	68qm
WC	15qm
Dressing-room	15qm
Storage	18qm
Preparation	18qm
Mixed Areas	50qm
Total	316 qm

10.06.96

All rights reserved.

1st floor: Auditorium

Our 5-m circular pool provides for a variety of water experiments. A shatter-proof glass cover slides over to create the right surface for all theatrical performances and creativity courses. The double circular wooden seating around the auditorium is designed to provide a good working surface, as well as a backrest for the row in front.

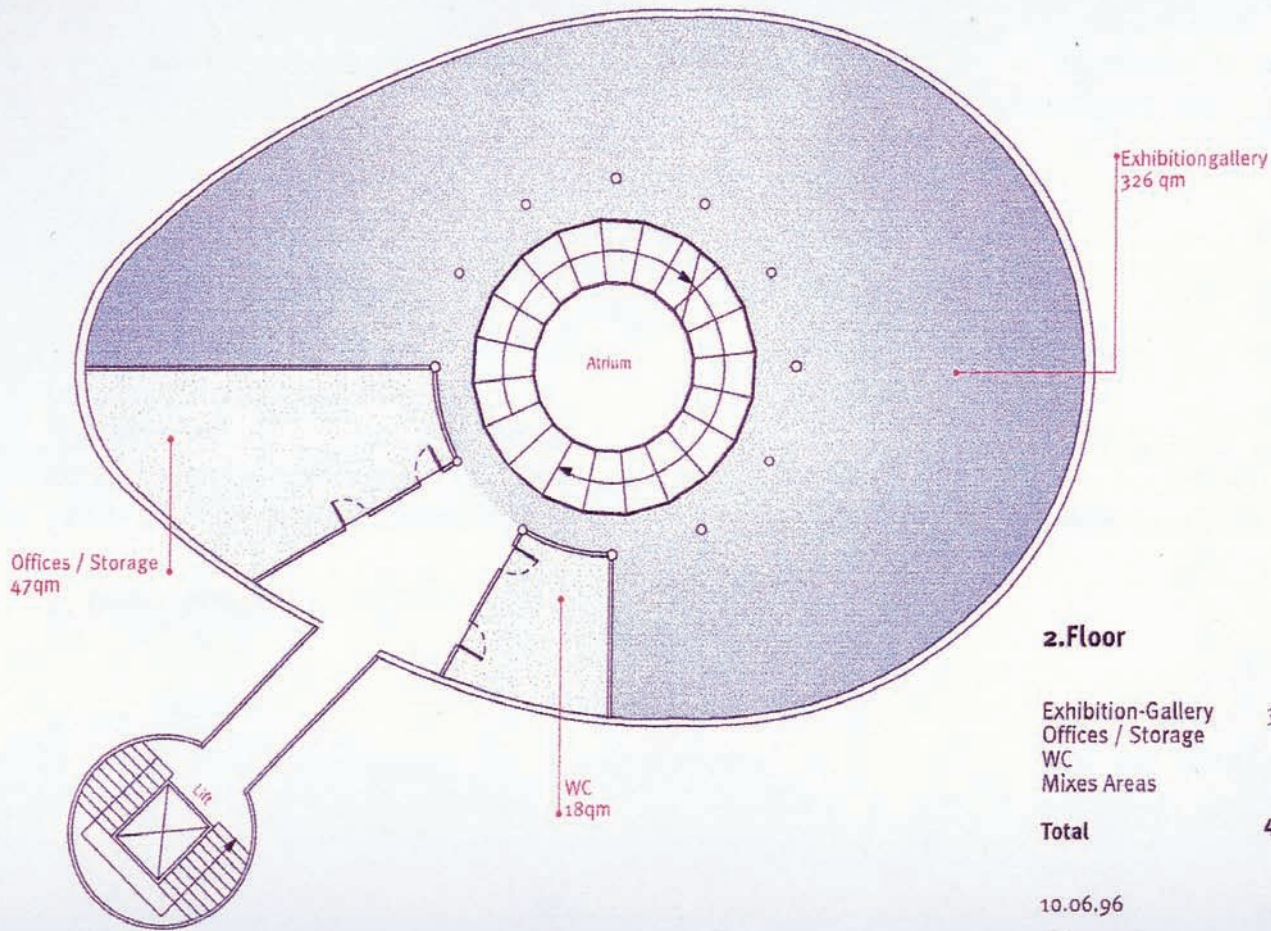

Exhibition gallery
326 qm

Atrium

Offices / Storage
47qm

WC
18qm

2.Floor

Exhibition-Gallery	326 qm
Offices / Storage	47qm
WC	18qm
Mixes Areas	23qm
Total	414 qm

10.06.96

All rights reserved.

2nd floor: Gallery

This large area will provide the space for all the necessary exhibits, hands on, multimedia and other features in order to accommodate the deep exploration of the subject chosen.

We see the learning experience not just as being entertaining, but simultaneously want to enable the visitor to see himself / herself in the role of the observer and therefore aware of intrinsic limitations:

Exploring the limitations of observation whilst locked in the „self“ as the „observer“.

To become aware of:

Who / What am I ?

What moves me ?

How do I work ?

How do I think ?

How do I relate / react / observe ?

Close up:

health / sickness

emotions / reactions

peace / war

joy / fear

Exploring the self in relation to mankind's evolution.

Exploring the self in relation to the totality of the movement of life / nature / universe.

Exploring the interdependencies.

Exploration into the limitations of „thought“.

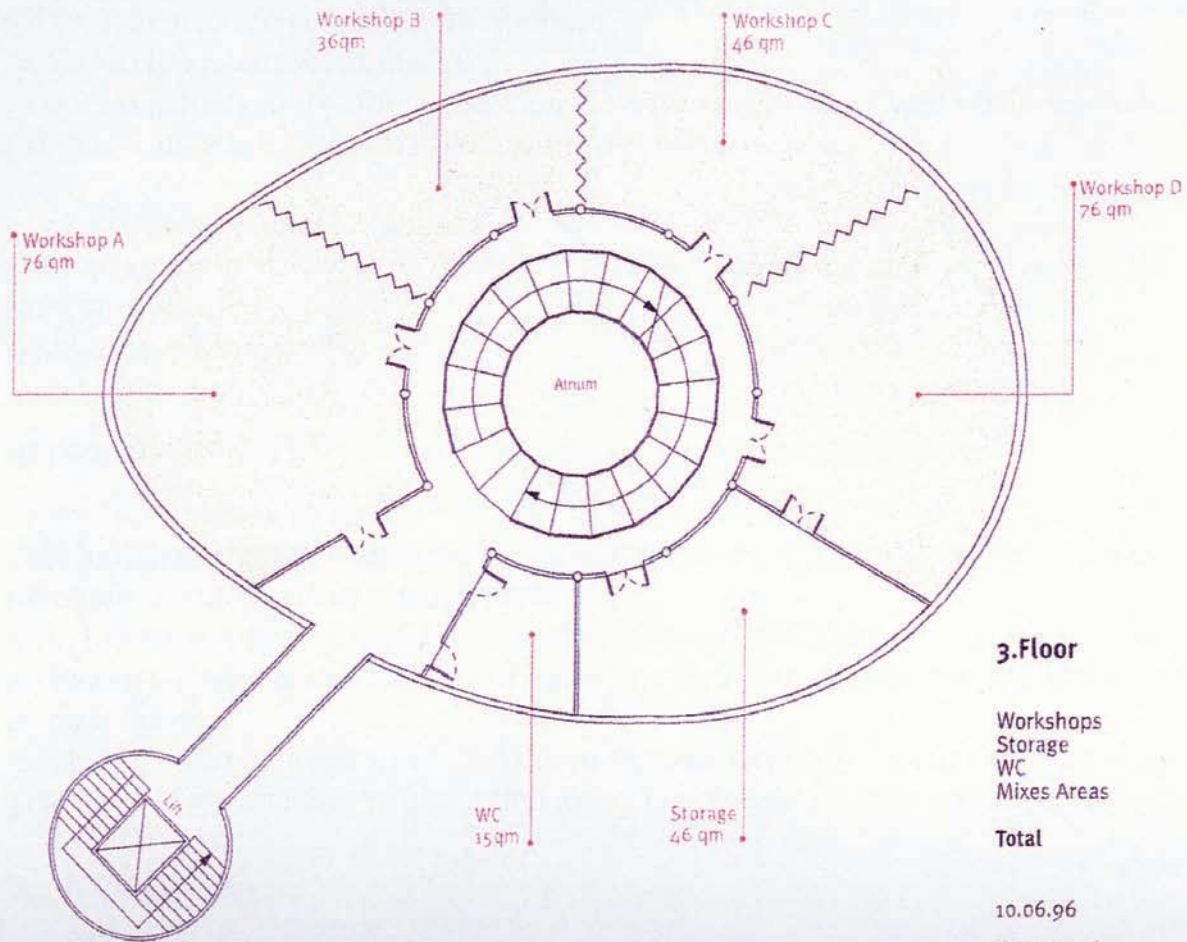

3.Floor

Workshops	234 qm
Storage	46 qm
WC	15 qm
Mixes Areas	21 qm
Total	316 qm

10.06.96

All rights reserved.

3rd floor: Workshops

This area could provide various enclosures for the required number of workshops / experimental areas.

A comprehensive mediatheque would provide the necessary knowledge stored for reference. This floor also provides storage and administration space.

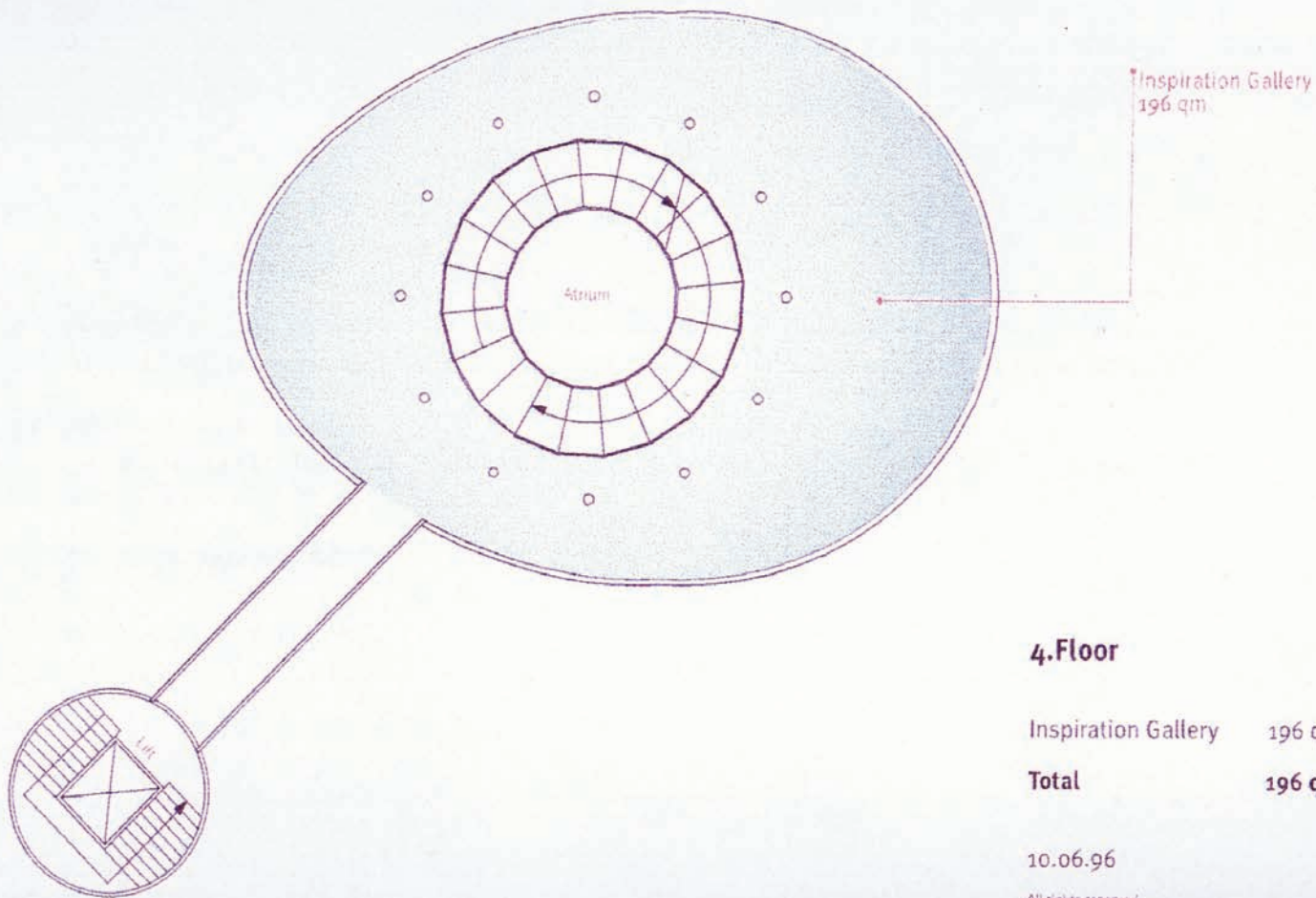

Inspiration Gallery
196 qm

4.Floor

Inspiration Gallery 196 qm

Total 196 qm

10.06.96

All rights reserved.

4th floor: Sleep / dream

The top floor is where activities stop. Here we rest, observe the universe, meditate - and new solutions may inspire the visitor through insight.

Further information:

The creative Egg has a circular skylight which reflects directly into the pool on ground level.

Kinetic mirrors deliver sun / daylight throughout the enclosure.

All rain / snow water is collected from the surface into the shadow oval pool which would supply water needs.

We intend this Egg to be built to the highest ecological standards and to function with the least degree of interference with nature.

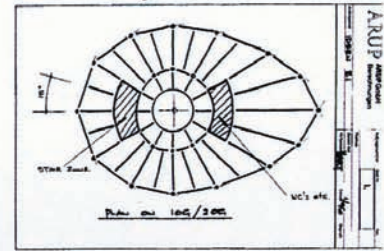
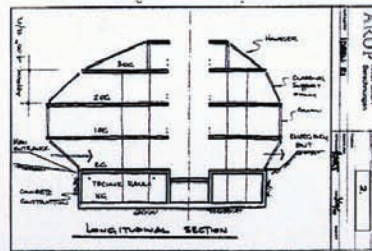
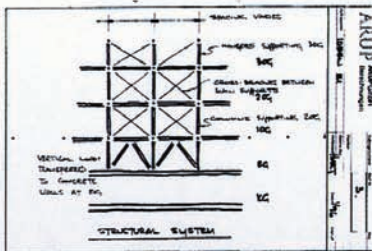

Biography

Shahla Ahy / Hänska

- 1944 Born in Tehran
- 1960 - 63 High School in England
- 1963 - 71 Art & Design degree at Ravensbourn College of Art, London
- 1968 - 71 Design in theatre, film and graphics, study of educational psychology & sociology
- 1970 - 80 Design and production of furniture and fashion with exports to Europe and the USA
- 1980 - 82 Involved in questions of education and a number of exhibitions in California
- 1983 - 97 Move to Berlin, involved in upbringing own children, and further involvement in art and design projects

Shahla Ahy Hänska, Am Sandwerder 28, D-14109 Berlin, Germany,
Tel/Fax 49 30 803 27 06, Shahla.Haenska@t-online.de